

User's Manual

CNPS7X LED+

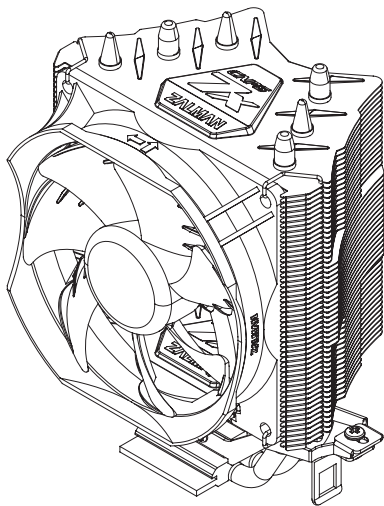

Intel Socket 115X / 775 CPUs
AMD Socket FM2+ / FM2 / FM1 / AM3+ / AM3 / AM2+ / AM2
CPU&APUs

To ensure safe and easy installation, please read the following precautions
Product design and specifications may be revised to improve quality and performance.

www.ZALMAN.com

Ver.150806

1 Precautions

- Avoid inserting objects or hands into the fan while it is in operation to prevent product damage and injuries.
- Do not ingest the Thermal Grease, and avoid its contact with skin and eyes. If contact is made with skin, wash off with water. If ingested or irritation persists, seek medical attention.
- To prevent possible injuries, gloves must be worn while handling this product.
- Excessive force exerted on the fan may cause damage to the fan and/ or system.
- Use and keep product away from reach of children.
- Check the components list and condition of the product before installation. If any problem is found, contact the retailer to obtain a replacement.
- During transportation of the system, the cooler must be removed. Zalman is not responsible for any damages that occur during the transport of a system.
- Product design and specifications may be revised to improve quality and performance.
- Enable PWM function in BIOS settings after installation.

Disclaimer) Zalman Tech Co., Ltd. is not responsible for any damages due to external causes, including but not limited to, improper use, problems with electrical power, accident, neglect, alteration, repair, improper installation, or improper testing.

2 Specifications

Model		CNPS7X LED+
Dimensions		104(L) X 85(W) X 134(H)mm
Weight		360g
Material		Pure Copper and Aluminum
Heat Dissipation Area		2,970cm ²
Fan	Dimension	Ø92 x 25(H)mm
	Speed	1,350 – 2,100RPM ±10%
	Noise Level	18 - 28dBA ±10%
	Bearing Type	Long Life Bearing
	Control Method	PWM Control, Auto Restart
Connector		4Pin
Input Voltage		12V
Socket		Intel Socket LGA 115X/775 CPUs AMD Socket FM2+/FM2/FM1/AM3+/AM3/AM2+/AM2 CPU & APU
Thermal Grease		ZM-STG2M(ver2)

3 Components

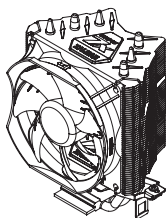

Cooler

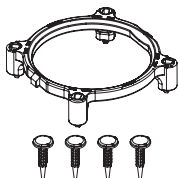

Clip Support & Pushpins
[For LGA 115X / 775]

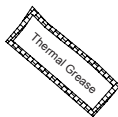

Thermal Grease

Manual

User's Manual

4 Installation Requirements

■ Space Requirements

The cooler's installation requires an unobstructed space of 85mm(width), 104mm(length) and 134mm(height) with the CPU as a central reference point. Please check if components such as ODDs and PSU protrude into the required space.

■ Air Guide Removal

Air guides on enclosures must be removed before the cooler's installation since they protrude into the cooler's required space.

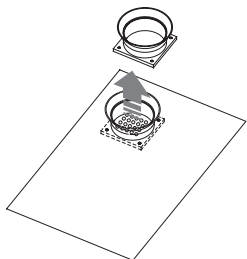
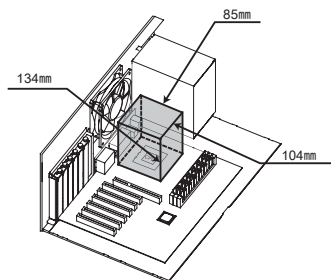

■ Cooler Orientation

As shown in the diagram below, it is recommended that the cooler be installed so that air flows from the cooler toward the enclosure's rear exhaust fan to be released.

※ Recommended cooler orientation may differ according to the motherboard model.

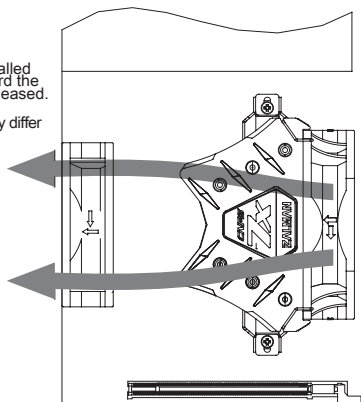

5 Installation

Intel Socket

■ Clip Support Installation(Socket 115X / 775)

Align the A-type Clip Support's lever with the socket type and fasten to the motherboard with pushpins.

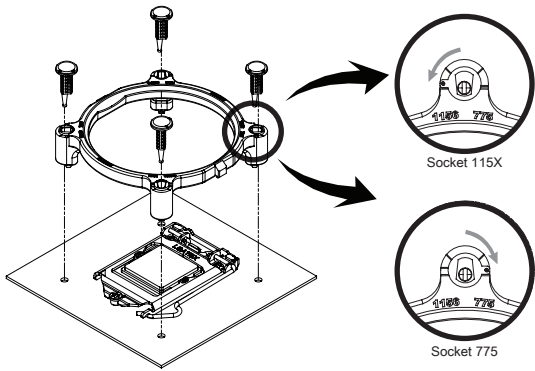

■ Clear off any particles or residue from the CPU's surface. Then spread a thorough layer of Thermal Grease on the CPU and the base of the cooler.

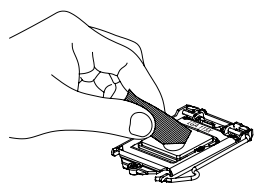

■ Completely unfasten the 2 bolts already assembled on the clip and adjust the position to fit the Intel socket.

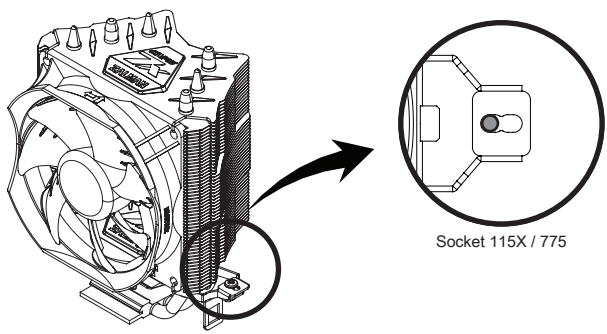

**Tip**

When reassembling the bolt, be sure to assemble only half way of the total length.

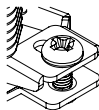

- Install the cooler on the Clip support as shown in the picture and connect the lug slot of the clip on to the lug on the clip support. Then fasten the bolts on each side a few turns at a time.

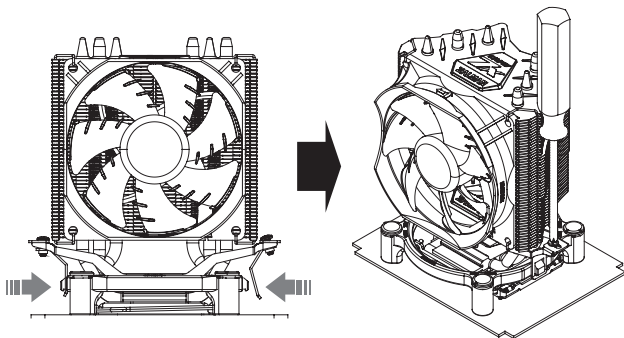

- Connect the cooler's 4-pin connector to the motherboard's CPU Fan Header.

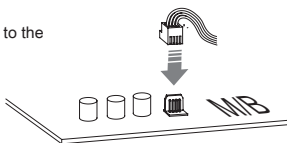
**Caution**

Please make sure that PWM Control Mode is activated in the motherboard's BIOS settings.

AMD Socket

- AMD Socket FM2+ / FM2 / FM1 / AM3+ / AM3 / AM2+ / AM2

Clear off any particles or residue from the CPU's surface. Then spread a thorough layer of Thermal Grease on the CPU and the base of the cooler.

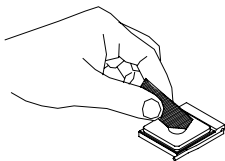

- Completely unfasten the 2 bolts already assembled on the clip and adjust the position to fit the AMD socket.

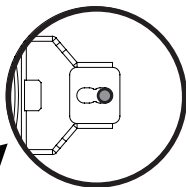
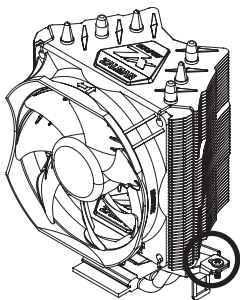

Socket FM2+ / FM2 / FM1 / AM3+ / AM3 / AM2+ / AM2

- Install the cooler on the Clip support as shown in the picture and connect the lug slot of the clip on to the lug on the clip support. Then fasten the bolts on each side a few turns at a time.

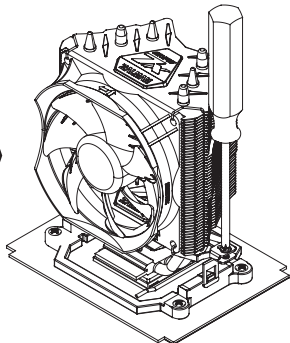
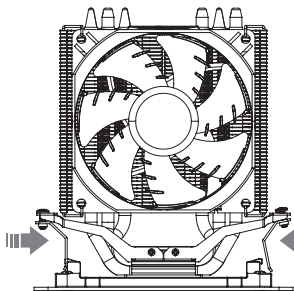

 **Tip**

When reassembling the bolt, be sure to assemble only half way of the total length.

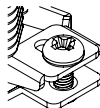

- Connect the cooler's 4-pin connector to the motherboard's CPU Fan Header.

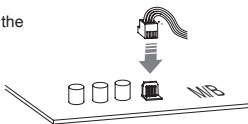

 **Caution**

Please make sure that PWM Control Mode is activated in the motherboard's BIOS settings.